

How to Orient a SIM Card in a LYNK Telemeter

The LYNK Telemeter features cellular connectivity via an installed SIM card.

The SIM card in a LYNK Telemeter must be placed in the top-left SIM card slot. For **Full Size** devices, the notched corner of the card should be visible and pointing upward. For **Overlay** devices, the notched corner of the card should be on the left and facing inward.

Correct SIM Orientation on Full Size LYNK :

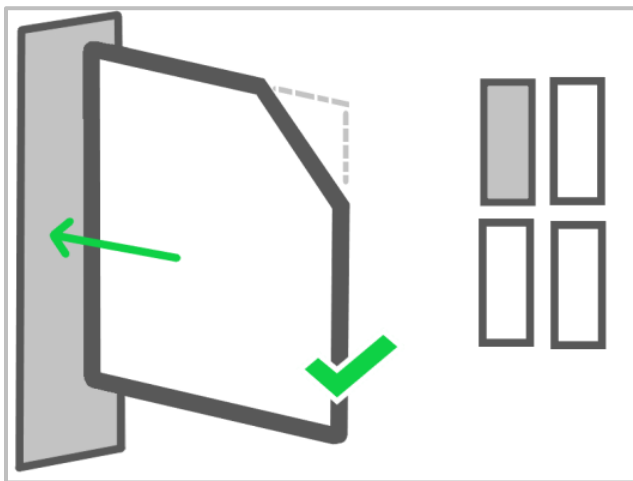

Correct SIM Orientation on Overlay LYNK:

